

SOLID SURFACE HEALTHCARE

SHIELD

FINALLY, HEALTHCARE PRODUCTS LAST A LIFETIME.

Durable, hygienic and nonporous, solid surface is a design standard countertop material for a reason and relied on for utmost performance. The downstream consequences of product failures can be easily underestimated when budgeting or making purchase decisions for built environments.

Shield holds patented methods of building with solid surface, so you can have long-lasting performance in any space. Very few manufacturers are willing to stand behind their products with a 24/7 performance guarantee. Our commitment to producing the best architectural products on the market shapes our unmatched, industry-leading limited lifetime warranty.

Don't just take our word for it; check out our cabinet that lived outside for an entire year:

SHIELDCASEWORK.COM/SHELFIE

Proudly manufactured in Kansas City, Missouri.



DOCUMENTATION STATIONS.....	04
CASEWORK.....	06
CUBE	06
WEDGE	08
INTERLOCKING PASS-THROUGH CABINETS.....	12
SPECIALTY STORAGE CABINETS.....	14
MOBILE CARTS	16
BEDSIDE CABINETS	18
HEADWALLS	22
CUSTOM SERVICES	24
FINISHES AND HARDWARE	26

DOCUMENTATION STATIONS



STANDARD MODELS

	STANDARD (DS01)	CHANNEL (DS02)	MINI (DS03)
CLOSED DIMENSIONS	48"W X 36"H X 48"D	54"W X 36"H X 48"D	60"W X 36"H X 24"D
SWIVEL WORKSURFACE	22"W X 33"H X 40"D	22"W X 33"H X 40"D	18"W X 33"H X 36"D
STATIONARY STORAGE	15"W X 28"H X 18"D	15"W X 28"H X 18"D (2)	12"W X 28"H X 18"D
SWIVEL STORAGE	12"W X 28"H X 18"D	12"W X 28"H X 18"D	12"W X 28"H X 18"D

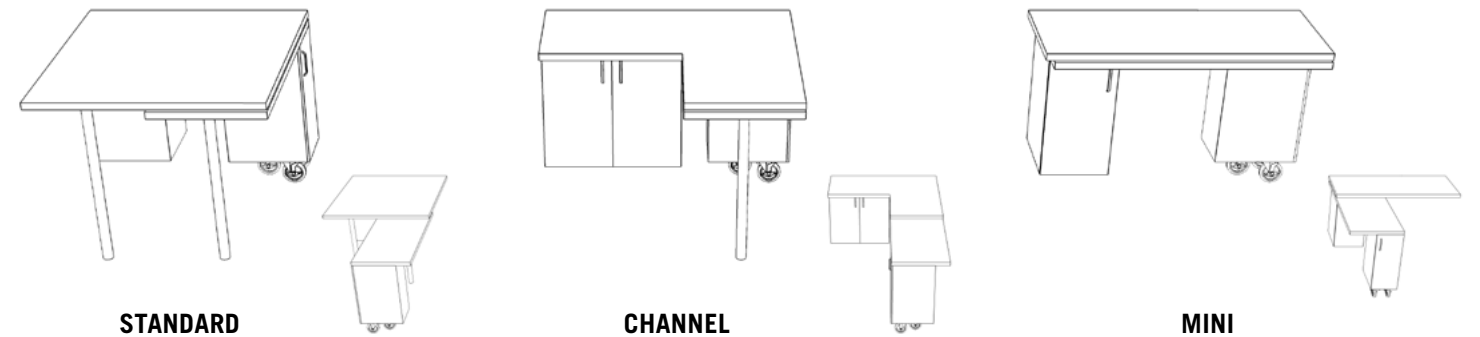

*Swivel locking casters, 60mm brushed aluminum furniture legs, and cabinet pulls included.

Shield's documentation stations are a system of solid surface workstations designed to overcome complex challenges of today's operating rooms. To help improve staff workflows, our signature swiveling, dual-worksurface construction adds flexibility and supports sterility in critical spaces.

ADDITIONAL OPTIONS

- HC01 Extra shelves (qty. 2, 1 per cabinet)
- HC02 Cabinet door routing for ventilation
- Cabinet locks (see *Hardware reference page*)
- Wall cabinets (see *Casework product page*)
- Premium tier countertop finish (see *Finishes reference page*)
- Build your own size and configuration

HOW TO SPECIFY

- Select model
- Select color finish (see *Finishes reference page*)
- Select additional options
- Select cabinet pull (see *Finishes reference page*)

KEY FEATURES

- Signature solid surface construction
- Flexible sizes to fit any space or design
- Easily cleaned and repairable to factory finish
- Craftsmanship backed by Shield's industry-leading limited lifetime warranty

CUBE CASEWORK



Our 100% acrylic solid surface modular casework is durable, seamless, non-porous, and microbial-resistant: the perfect solution for any healing environment. These unique cabinets are designed for repeated clinical-grade disinfectanting and require very low maintenance to help improve sanitation and maximize the lifetime value of your investment.

KEY FEATURES

- Designed for critical, sanitary environments: 100-percent solid surface cabinet build
- Patented, embedded metal-on-metal hardware connections
- Fully modular cabinet construction
- Soft-close door and drawer hardware
- Flexible sizing: 3-inch increments from 9 to 40-inch widths

CUBE CASEWORK



- 1** Patented metal-to-metal connections provide utmost durability in places most susceptible to failure. Hardware fails before Shield's connection points.
- 2** 100% solid surface cabinet construction allows us to guarantee your investment with an industry-leading limited lifetime warranty.
- 3** Digital manufacturing techniques precision cuts each piece of the cabinet for assembly, allowing us to offer mass customization at an affordable price.
- 4** Chemical welds make a seamless joint construction, because patients, caregivers, and facility patrons deserve a more hygienic, cleanable and microbial-resistant product.
- 5** Modular, prefabricated construction not only reduces manufacturing cost, but adds flexibility for renovation plans down the road.

WEDGE CASEWORK



The Wedge casework line offers budget and design flexibility to our signature Cube casework. Commonly used in lieu of custom millwork, the Wedge has standard sizes and configurations pre-manufactured to spec. Easily customize finishes to match any space or design scheme while maintaining the strength, durability, and cleanability of acrylic solid surface where you need it the most.

KEY FEATURES

- Fully modular cabinet construction
- Shield's patented solid surface construction with inset wood or laminated door/drawer faces
- Patented, embedded metal-on-metal hardware connections
- Soft-close door and drawer hardware
- Flexible sizing: 3-inch increments from 9-inch to 40-inch widths

WEDGE CASEWORK

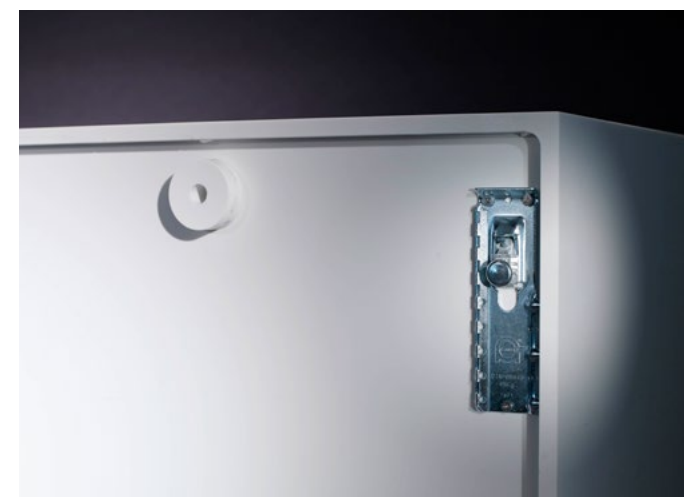

- 1** Patented metal-to-metal connections provide utmost durability in places most susceptible to failure. Hardware fails before Shield's connection points.
- 2** Our solid surface body features an inset wood door so that your cabinets are taking the most abuse where materials are the strongest.
- 3** Wedge reduces cost by using melamine for cabinet backs, shelves and drawer bodies, but increases design flexibility. Commonly used in lieu of standard plam cabinets.
- 4** Chemical welds make a seamless joint construction, because patients, caregivers, and facility patrons deserve a more hygienic, cleanable and microbial-resistant product.
- 5** Modular, prefabricated construction not only reduces manufacturing cost, but adds flexibility for renovation plans down the road.

CABINET MODELS

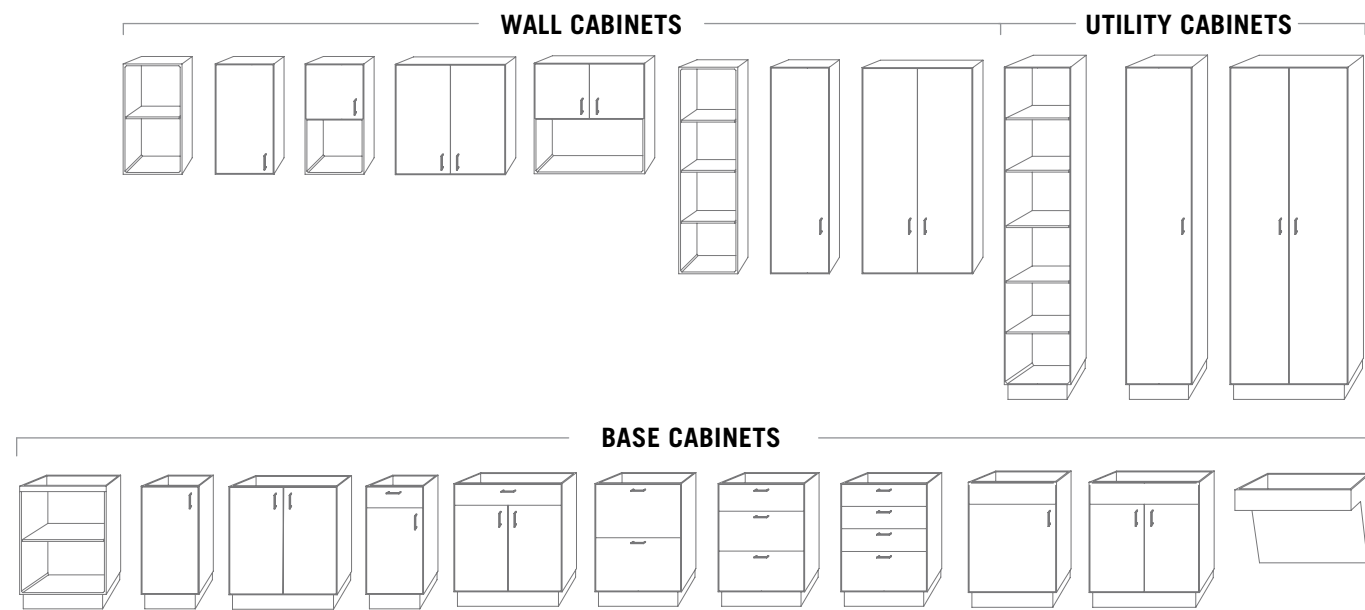

PRODUCT INCLUDES

- 4" waterproof toekick substrate
- Door hinges and/or drawer glide hardware
- 1 shelf per open/door cabinet with 4 shelf pins
- Adjustable shelf holes provided in 1" increments
- Standard cabinet pulls (*qty. varies, see hardware reference page*)

STANDARD HINGES



IN - 3-Knuckle Industrial



CN - European Concealed

ADDITIONAL OPTIONS

- HC01 Extra shelves
- HC02 Routing for cabinet ventilation
- HC04 High-density storage components
- Cabinet locks (*see Hardware reference page*)
- HC07 Glass doors
- HC08 Undercabinet task lighting
- HC09 Sloped tops
- HC10 Behavioral health modifications: anti-ligature hardware, rounded edges, specialty locking system
- HC11 Drawer organizers

HOW TO SPECIFY

- Select model
- Select hinges
- Select solid surface finish (*see Finishes reference page*)
- Select cabinet pull (*see Hardware reference page*)
- Note any additional options
- Select solid surface countertop finish (*sum linear feet of base units*)

CABINET SIZES

	BASE CABINETS (W x H x D)			WALL CABINETS (W x H x D)			UTILITY CABINETS (W x H x D)		
	VARIES* X 28" X 24"			VARIES* X 24" X 14.5"			VARIES* X 68" X 24"		
BASE CABINETS	12"W	15"W	18"W	21"W	24"W	27"W	30"W	33"W	36"W
OPEN	[Line spanning all widths]								
FULL HEIGHT (SINGLE DOOR)	[Line spanning 12" to 27"]								
FULL HEIGHT (DOUBLE DOOR)	[Line spanning 30" to 36"]								
ONE DRAWER (SINGLE DOOR)	[Line spanning 12" to 27"]								
ONE DRAWER (DOUBLE DOOR)	[Line spanning 30" to 36"]								
TWO DRAWER	[Line spanning 15" to 36"]								
THREE DRAWER	[Line spanning 15" to 36"]								
FOUR DRAWER	[Line spanning 15" to 36"]								
MICROWAVE	[Line spanning 21" to 36"]								
SINK BASE, FULL	[Line spanning 21" to 36"]								
SINK BASE, ADA	[Line spanning 21" to 36"]								
WALL CABINETS	12"W	15"W	18"W	21"W	24"W	27"W	30"W	33"W	36"W
OPEN	[Line spanning all widths]								
SINGLE DOOR	[Line spanning 12" to 27"]								
DOUBLE DOOR	[Line spanning 30" to 36"]								
MICROWAVE	[Line spanning 21" to 36"]								
UTILITY CABINETS	12"W	15"W	18"W	21"W	24"W	27"W	30"W	33"W	36"W
OPEN	[Line spanning 18" to 36"]								
SINGLE DOOR	[Line spanning 18" to 30"]								
DOUBLE DOOR	[Line spanning 30" to 36"]								

PASS-THROUGH CABINETS



Designed for sterile and non-sterile cleanrooms, Shield USP 797 and USP 800 compliant interlocking pass-through cabinets offer pharmacists and clinicians a less expensive and more durable alternative to similar stainless steel models. Ideal for ORs, labs pharmacies and other cleanroom environments, Shield's proprietary construction comes with lifetime protection.

KEY FEATURES

- Shield's signature 100-percent solid surface cabinet, with embedded metal-on-metal connections
- Designed for critical, sanitary environments
- Gasket seal around shatterproof Lexan doors
- Automatic magnetic interlock (locks opposite door when opened)
- Step-saving workflow indicator light

STANDARD MODELS & SIZES

WALL	(W X D X H)	CART	(W X D X H)	FULL-HEIGHT	(W X D X H)
PTWA15	15" X 15" X 15"	PTCA24	24" X 30" X 48"	PTFH24	24" X 30" X 72"
PTWA18	18" X 18" X 18"	PTCA30	30" X 30" X 48"	PTFH30	30" X 30" X 72"
PTWA2418	24" X 18" X 24"	PTCA36	36" X 30" X 48"	PTFH36	36" X 30" X 72"
PTWA2424	24" X 24" X 24"	PTCA42	42" X 30" X 48"	PTFH42	42" X 30" X 72"
PTWA30	30" X 30" X 30"	PTCA48	48" X 30" X 48"	PTFH48	48" X 30" X 72"
PTWA36	36" X 36" X 36"	PTCA54	54" X 30" X 48"	PTFH54	54" X 30" X 72"
PTWA00	CUSTOM SIZE	PTCA60	60" X 30" X 48"	PTFH60	60" X 30" X 72"
		PTCA00	CUSTOM SIZE	PTFH00	CUSTOM SIZE

NOTE: All dimensions above are OD. To determine interior clear dimensions for wall model, subtract 5" from width, 1.5" from depth, and 3.5" from height. Contact Shield Casework for additional details on Cart and Full-Height model interior clear dimensions.

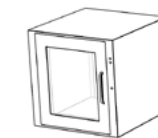

WALL



CART

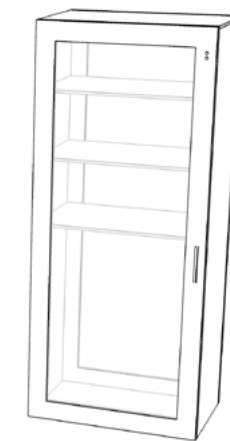

FULL-HEIGHT

PRODUCT INCLUDES

- LED Workflow indicator light (green/red)
- Electronic magnetic interlock with door gasket
- Lexan shatterproof doors
- Shield standard wire door pull (3 finish options)
- 120V Power supply and junction box for electrical connection
- Side wall and top access panels for easy installation and maintenance

HOW TO SPECIFY

- Select model
- Select size (or specify custom size)
- Select color finish (see *Finishes reference page*)
- Select door pull finish (see *Finished reference page*)
- Note any additional options

ADDITIONAL OPTIONS

- HC03 LED capacity indicator light with infrared sensor
- HC04 High-density storage components
- HC05 HEPA filtration system

SPECIALTY CABINETS



STANDARD MODELS & SIZES

SCOPE/ENDOSCOPY (SCEN)	TEE PROBE (SCTP)	CATHETER (SCCH)	TECHNOLOGY/AV (SCAV)	HIGH-DENSITY (SCHD)
24"- 36"W X 92"H X 28"D	24"- 36"W X 92"H X 28"D	24"- 36"W X 80"H X 28"D	24"- 36"W X 92"H X 34"D	24"- 36"W X 92"H X 28"D
SCEN24R RHR DOOR SCEN24L LHR DOOR SCEN30 DOUBLE DOOR SCEN36 DOUBLE DOOR	SCTP24R RHR DOOR SCTP24L LHR DOOR SCTP30 DOUBLE DOOR SCTP36 DOUBLE DOOR	SCCH24R RHR DOOR SCCH24L LHR DOOR SCCH30 DOUBLE DOOR SCCH36 DOUBLE DOOR	SCAV24R RHR DOOR SCAV24L LHR DOOR SCAV30 DOUBLE DOOR SCAV36 DOUBLE DOOR	SCHD24R RHR DOOR SCHD24L LHR DOOR SCHD30R DOUBLE DOOR SCHD30L DOUBLE DOOR

NOTE: RHR is Right Hand Reverse door swing, and LHR is Left Hand Reverse door swing.

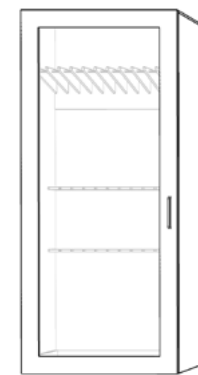

SCOPE/ENDOSCOPY

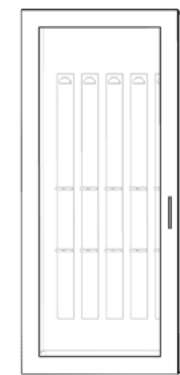

TEE PROBE

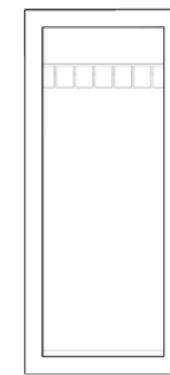

CATHETER STORAGE



TECHNOLOGY/AV

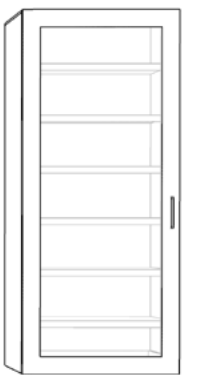

HIGH-DENSITY

From endoscopy to high-density storage, Shield's specialty cabinets combine the fundamental durability and cleanliness of our 100% acrylic solid surface casework with specialized storage and functionality for specific, clinical workflows. Customize your next OR, cath lab, surgical pathology lab, pharmacy, etc. with this lifetime-guaranteed alternative to stainless steel.

KEY FEATURES

- SCOPE/ENDOSCOPY
- TEE PROBE
- CATHETER STORAGE
- TECHNOLOGY/AV
- HIGH-DENSITY

PRODUCT INCLUDES

- 4" waterproof toekick substrate
- Concealed, soft-close door hinges
- Standard wire cabinet pulls (*qty. varies, see Hardware reference page*)

ENDOSCOPY: Includes top and bottom ventilation, scope padding, removable drip tray, adjustable scope cues, and cord management.

TEE PROBE: Includes ventilation top and bottom, and removable drip tray.

CATHETER: Includes upper storage shelf and either 3, 6, or 8 cues.

TECHNOLOGY: Includes 2 fixed full-depth shelves and 2 pull-out shelves on heavy duty drawer glides; cabinet ventilation and removable access panel.

PPE: Includes glove cutouts for sizes plus glove box storage rack on interior; interior shelf for storing other items.

ADDITIONAL OPTIONS

- HC01 Extra shelves
- HC02 Cabinet ventilation
- HC04 High-density storage components
- Cabinet lock (*see Hardware reference page*)
- HC05 HEPA filtration system
- HC07 Glass doors
- HC08 Undercabinet lighting
- HC09 Sloped tops

HOW TO SPECIFY

- Select model
- Select finish (*see Finishes reference page*)
- Select cabinet pulls (*see Hardware reference page*)
- Note any additional options

MOBILE CARTS

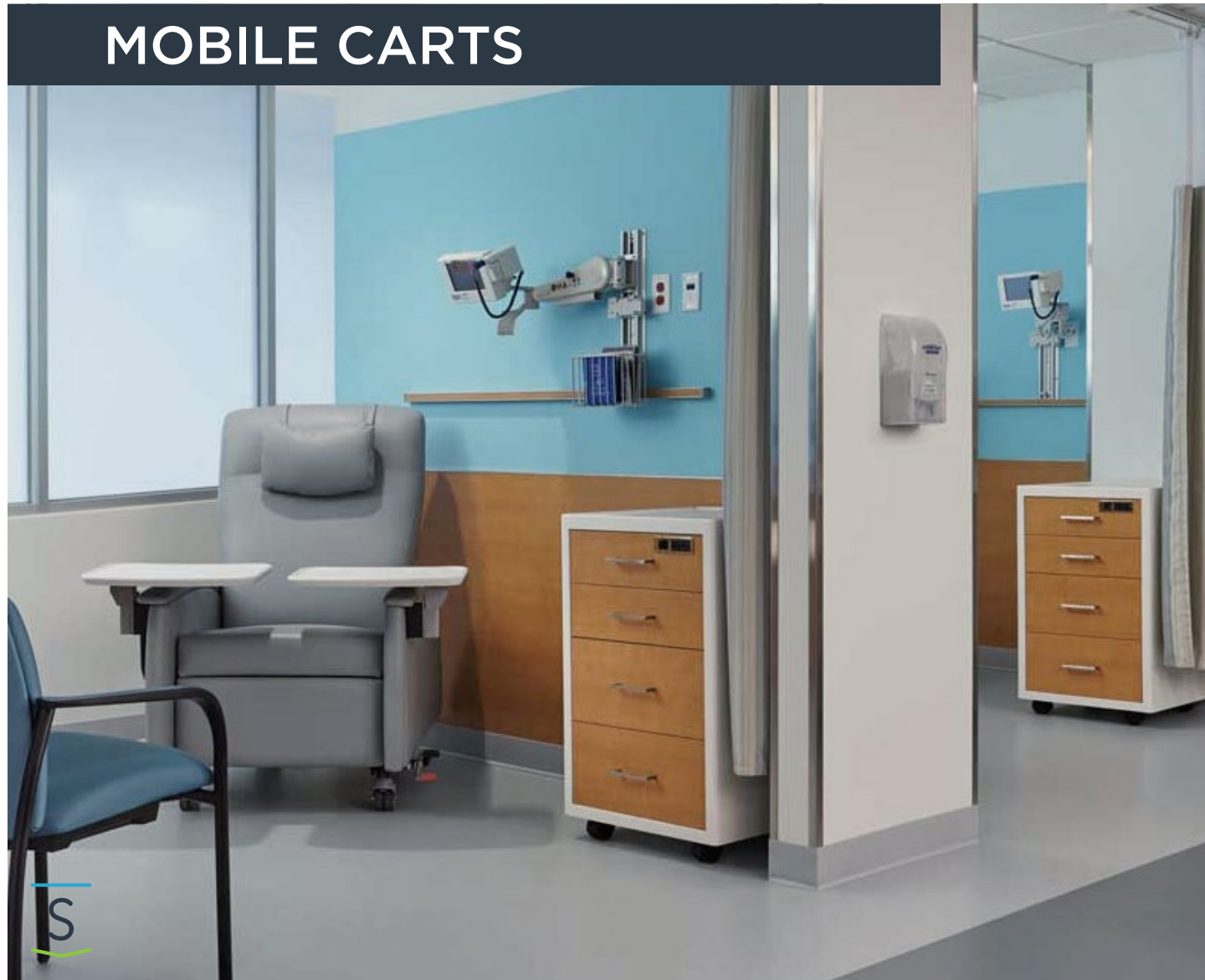

Designed for hospital and healthcare environments that are constantly changing, acrylic solid surface mobile carts offer caregivers a flexible, bleach cleanable, and secured supply and procedure storage solution. Commonly used in exam rooms, as well as cancer or dialysis infusion therapy spaces, these carts help support infection prevention, especially in areas with immunosuppressed patients.

KEY FEATURES

- Solid surface frame with wood-look door/drawer faces
- Patented, embedded metal-on-metal connections
- Anti-spill ledge prevents instruments from rolling off
- Multiple locks available standard
- Customizable workflow: choose the number of doors and drawers

STANDARD MODELS

MODEL	DIMENSIONS	STORAGE OPTIONS
TREK	22"W X 35"H X 22"D	PCTK4D 4-DRAWERS PCTK3D 3-DRAWERS PCTKDC 1-DRAWER, 1-DOOR
ROVE	22"W X 30"H X 22"D	PCRV3D 3-DRAWERS PCRV2D 2-DRAWERS



TREK



ROVE

PRODUCT INCLUDES

- Shield standard locking swivel casters (qty. 4)
- Standard cabinet pulls (*see Hardware reference page*)
- Soft-close drawer glides and concealed hinges
- Anti-spill inset edge on cart top

ADDITIONAL OPTIONS

- Cabinet lock (*see Hardware reference page*)
- HC06 Solid surface drawers/doors
- HC11 Molded plastic drawer organizers
- HC12 Medical grade power strip

HOW TO SPECIFY

- Select model (*or specify custom size*)
- Choose number of doors, drawers or open shelves
- Select solid surface body finish (*see Finishes reference page*)
- Select wood laminate door/drawer finish (*see Finishes reference page*)
- Select drawer pulls (*see Hardware reference page*)
- Note any additional options

BEDSIDE CABINETS



Bedside cabinets often claim to be designed for healthcare, but often struggle to hold up against bacteria-fighting clinical cleaners used regularly by environmental services. Shield's compact, acrylic solid surface bedside cabinets offer bleach cleanable storage and security for patients, visitors, and their caregivers during a patient's stay in acute care.

KEY FEATURES

- Solid surface build with optional laminate drawer faces
- Patented, embedded metal-on-metal connections
- Routed drip edge prevents items or spills from rolling off
- Three size options: choose the best fit for your space

STANDARD MODELS

MODEL	DIMENSIONS	STORAGE OPTIONS	
MATURE	24"W X 30"H X 16"D	BCMA2D	2-DRAWERS
		BCMA1D	1-DRAWER, 1-DOOR
SHIFT	16"W X 28"H X 14"D	BCSH3D	3-DRAWERS
		BCSH2D	2-DRAWERS
		BCSH1S	2-DRAWERS, 1-OPEN SHELF
VEER	16"W X 28"H X 14"D	BCVE3D	3-DRAWERS
		BCVE2D	2-DRAWERS
		BCVE1D	1-DRAWER, 1-OPEN SHELF

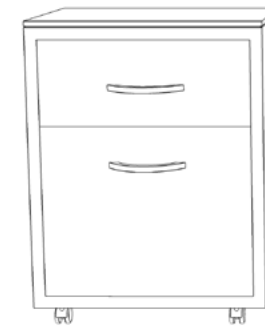

MATURE



SHIFT

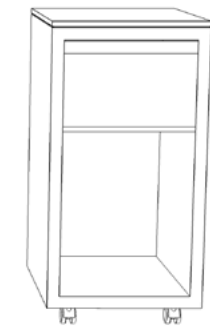

VEER

PRODUCT INCLUDES

- Shield standard locking swivel casters (qty. 4)
- Standard cabinet pulls (*see Hardware reference page*)
- Soft-close drawer glides and concealed hinges

ADDITIONAL OPTIONS

- Cabinet lock (*see Hardware reference page*)
- FN01 Power grommet
- FN02 Inductive charging
- FN03 USB port
- FN07 Solid surface drawer faces (matches body color)
- Build your own size and configuration

HOW TO SPECIFY

- Select model
- Select storage option
- Select finish (*see Finishes reference page*)
- Select drawer pull (*see Hardware reference page*)
- Note any additional options

BEDSIDE CABINETS



MONOLITH STANDARD MODELS

MODEL	DIMENSIONS (W x H x D)	STORAGE OPTIONS
ORIGINAL	24"W X 30"H X 16"D	MLOG2D 2-DRAWERS
		MLOG1D 1-DRAWER, 1-OPEN SHELF
MINI	24"W X 24"H X 16"D	MLMN2D 2-DRAWERS
		MLMN1D 1-DRAWER, 1-OPEN SHELF
COFFEE TABLE	36"W X 18"H X 16"D	MLCT2D 2-DRAWERS
		MLCT1D 1-DRAWER, 1-OPEN SHELF

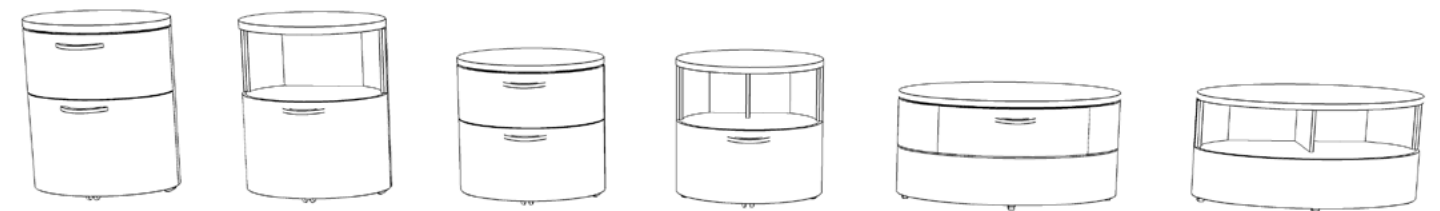

ORIGINAL

MINI

COFFEE TABLE

Shield's solid surface Monolith bedside cabinets showcase minimalist style and sleek curvature with lifetime durability. This thermoformed, bleach-cleanable acrylic solid surface design is engineered to support environmental cleanliness and infection control efforts with a unique, stunning aesthetic for patients and their care teams.

KEY FEATURES

- One-of-a-kind thermoformed solid surface design
- Minimal reveals disguise seams
- Storage options to meet any need
- Locking casters allow for easy movement – and reliable rest
- Optional charging add-on features

PRODUCT INCLUDES

- Shield standard locking swivel casters (qty. 4)
- Standard cabinet pulls (*see Hardware reference page*)
- Soft-close drawer glides and concealed hinges

ADDITIONAL OPTIONS

- FN01 Power grommet
- FN02 Inductive charging
- FN03 USB port
- Build your own size and configuration

HOW TO SPECIFY

- Select model
- Select storage option
- Select finish (*see Finishes reference page*)
- Note any additional options
- Shield standard curved pull only in 3 finish options (*see Hardware reference page*)

HEADWALLS



Shield Casework's headwalls enclose a high-tech core in an envelope of comfortable, curving lines. Our patented acrylic solid surface paneling gives you the ability to create an organic and flowing aesthetic that softens and uniquely defines the space. Connections are strategically placed at various points on the wall according to room function, layout, and workflows. All the while, smart materials help prevent infections and withstand hospital-grade disinfectants without staining or deteriorating.

KEY FEATURES

- Shield's signature solid surface construction with patented metal-on-metal connections
- Technology and med gas connections integrated within an innovative core
- Embedded lighting capabilities allow patients or staff to control their environment
- Modular, pre-fabricated construction allows for a kit of parts assembly on-site

PROJECTS



Image © Craig Dugan Photography.



CUSTOM SERVICES



Innovation-driven clients challenge the status quo of products that occupy their spaces. You don't have to buy widgets from a catalog, even if it's our widgets. Bring us specific goals for a space or vision for a product and we'll work with end users, owners, and designers to collaboratively develop something unique.

KEY FEATURES

- Consultative design services that start with a sketch, drawings, or simply an idea
- Initial budgeting and proposal support
- Collaborative design process with stakeholders
- Tailored specifications and value engineering for mass customization
- Optional mock-up process - get what you want, and test it first

CUSTOM PROJECTS



FINISHES

SOLID SURFACE

* CERTIFIED FOR OUTDOOR USE

STANDARD

PREMIUM

OUTDOOR



WOOD LAMINATE



METAL

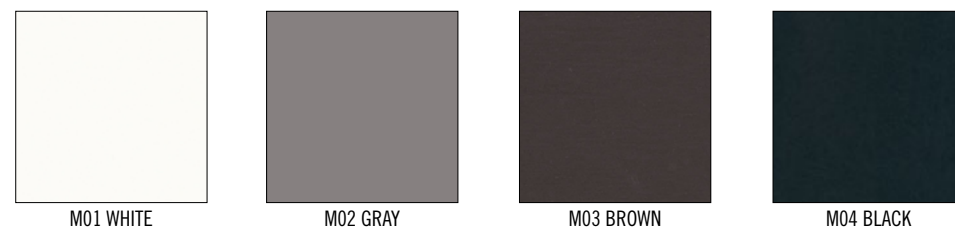

HARDWARE & ACCESSORIES

PULL OPTIONS

NON-FERROUS HARDWARE AVAILABLE BY REQUEST

STANDARD

PREMIUM

* MONOLITH ONLY



LOCK OPTIONS



SHIELD



Advanced products.
Cutting-edge manufacturing techniques.
Customizable solutions.

EMAIL info@shieldcasework.com **PHONE** 816.875.3317
ADDRESS 1120 Ellerbrook Road, North Kansas City, MO 64116